

QMF41 Jan. 2008

CONTOURED TRAYS

Provide estimate only Order

Wheelchair Service..... Date

Contact Name Title

Client Name Ref No.

Delivery Address

.....Postcode.....

Tel No Fax No Email.....

Wheelchair manufacturer and model

Size Type of Sidearm

Tray Specification	Part No.	Tick as required
• Tray made from 9mm birch ply, Formica top surface with width adjustable chrome brackets	L5-P28/#	<input type="checkbox"/>
• Tray made from 9mm birch ply, Formica top surface with swing over mounting bracket	L5-P32/#	<input type="checkbox"/>
• Clear Plastic Tray, with width adjustable chrome brackets and rolled edge to front and sides	L5-P30/#	<input type="checkbox"/>
• Clear Plastic Tray, with swing over mounting bracket and rolled edge to front and sides	L5-P45/#	<input type="checkbox"/>

If ordering by part number only, please state "small", "medium" or "large"

Tray Sizes (THIS SECTION MUST BE COMPLETED)

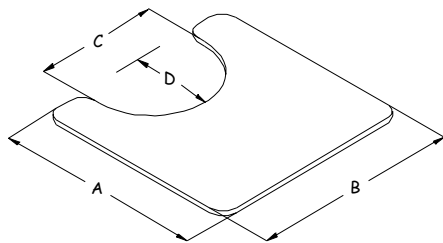

Small	A=510mm	B=510mm	
	C=330mm	D=150mm	<input type="checkbox"/>
Medium	A=560mm	B=560mm	
	C=360mm	D=200mm	<input type="checkbox"/>
Large	A=610mm	B=610mm	
	C=430mm	D=225mm	<input type="checkbox"/>

Square tray cut-out for special seating

Tray edging for plywood trays to front and sides

Special Build (please enter sizes)

A: _____ B: _____ C: _____ D: _____ L5-P31

Cut out for wheelchair control R/H L/H

State size of cut out and controller type _____

Bracket options (not for swing over trays)

Tray Receiver Sockets	Fixed Angle	<input type="checkbox"/>
	Angle Adjustable	<input type="checkbox"/>
Grab bar	L5-P36-F3	<input type="checkbox"/>

Comfort Pads

Dark grey vinyl pad covering rear third of tray depth L5-P33-#

If ordering by part number only, please state "small", "medium" or "large"

Alternative upholstery colour - please state _____